

# Hands-Off™ Chisel Grip Product Specification



## Materials

Handle:	Thermoplastic elastomer over-molded on high-density ABS plastic
Outer adjustment assembly:	
Adjustment dial:	High density ABS plastic
Threaded adjustment rod:	Bronze, type 2600
Inner adjustment assembly:	
Strap:	Nylon fabric with rubberized, high-grip surface
Banding:	Steel, with integral ¼ inch adjustment nut and steel rivets

## Technical

Weight:	5.4 ounces
Length:	
Handle length:	6.0 inches
Threaded adjustment rod:	3.30 inches total length 2.00 inches (50.4mm) thread length
Complete inner adjustment assembly:	5.70 inches
Total:	Adjustable:
	Minimum 6-7/8 inches
	Maximum 8-9/16 inches

# User Guide for

# MSA Tool Holder

6" Tool Holder & 18" Tool Holder - Model Numbers: 507003, 507004, 507005, 507006

## Purpose:

For safe holding of large sledge-driven tools, such as stone points, star drills, chisels, frost pins, gouges, ground rods, jack bits, punches, and marking dies.

## Set-up:

### STEP 1:

Loosen knob or T-handle, allowing slack in tool strap

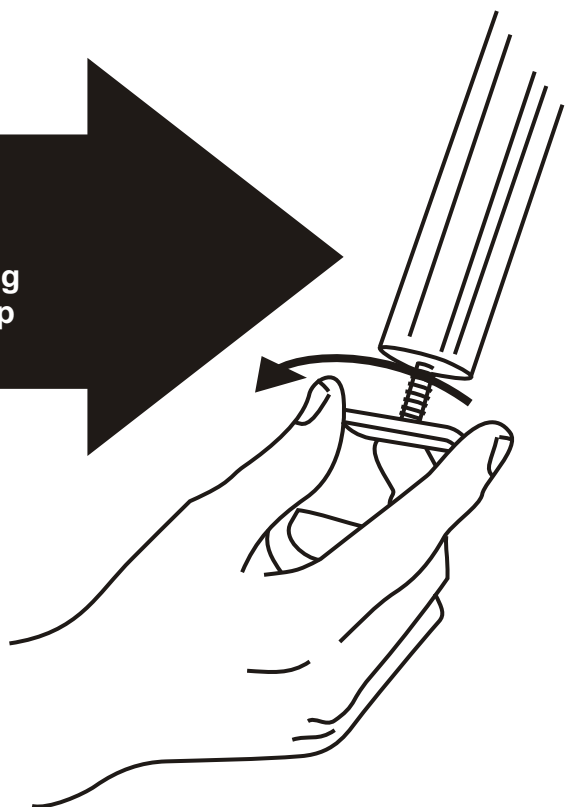

### STEP 2:

Pull on tool strap to gain some slack in the strap

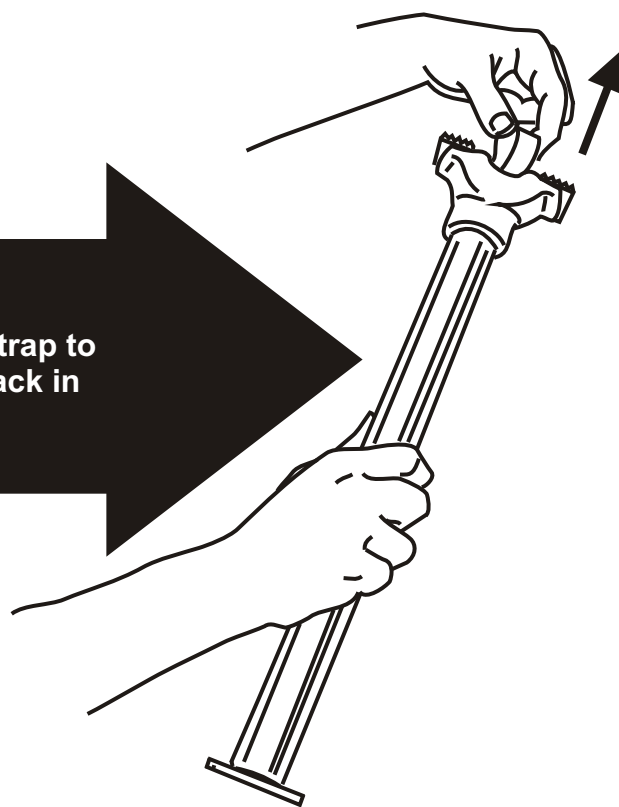

### STEP 3:

Place tool (i.e. chisel) into tool holder so that tool is inside strap and resting on pads

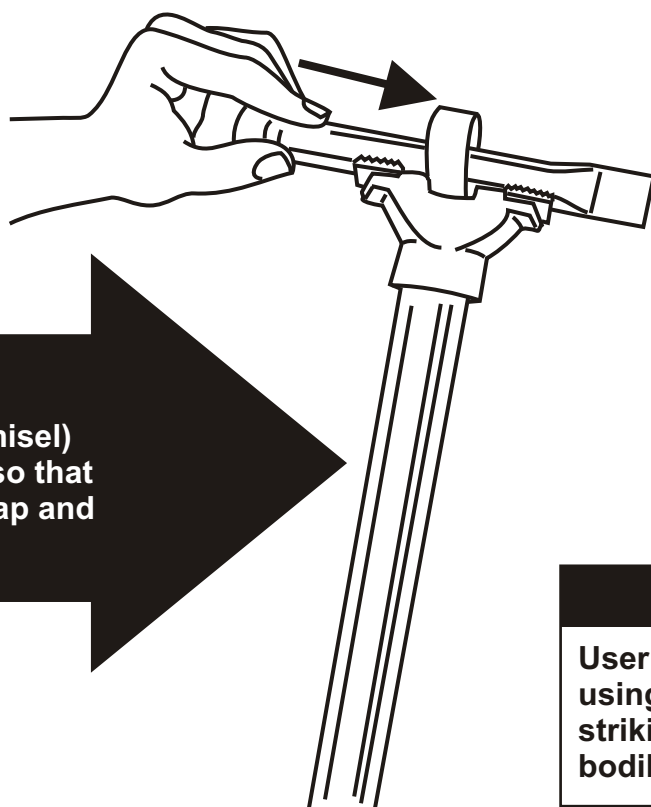

### STEP 4:

While holding tool in place, tighten strap by twisting T-handle in clockwise direction until tool is securely in place



### ! WARNING

User must wear eye protection while using this product. Debris created by striking objects can result in eye or other bodily injury.

## Use:

### CORRECT USAGE:

Grasp Tool Holder, keeping your hand away from striking tool. Place striking tool against desired surface. Strike tool.

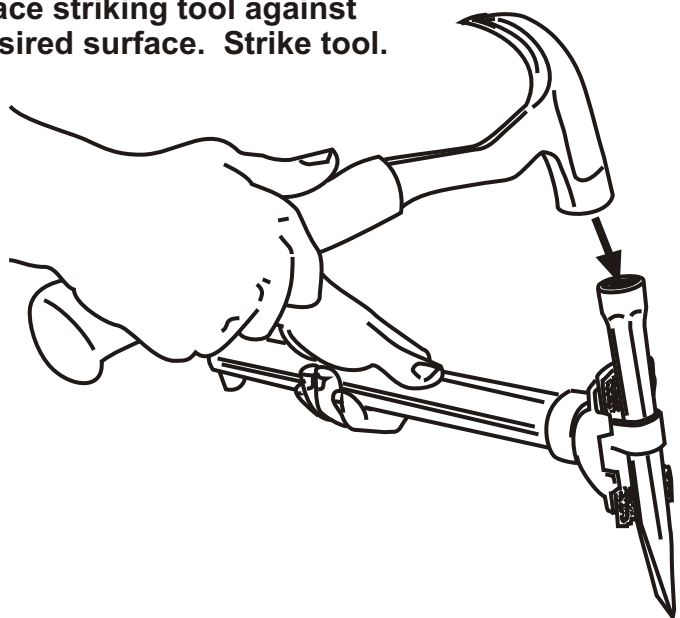

### INCORRECT USAGE:

DO NOT strike tool in the direction that pulls directly against the straps. Tool Holder is not intended to be used as a prying tool or with a hammer wrench.

